

GENERAL INFORMATION

lamptype	A60 (or CFL or LEDLAMP)
fitting	E27
watt	max.23W (for designer bulb: 7W / 470lm / CRI>80 / 2700K)
voltage	230V AC / 50Hz
gear	Mains operation
ip/class	IP20 - class 1
application	Interior use
orientation	Ceiling mounted
dimmiability	see lamp (for designer bulb: R or RL)
safe distance to object	Direct mountable on normally flammable surfaces

1 CUT OUT DIMENSIONS 150 X 150 H80:

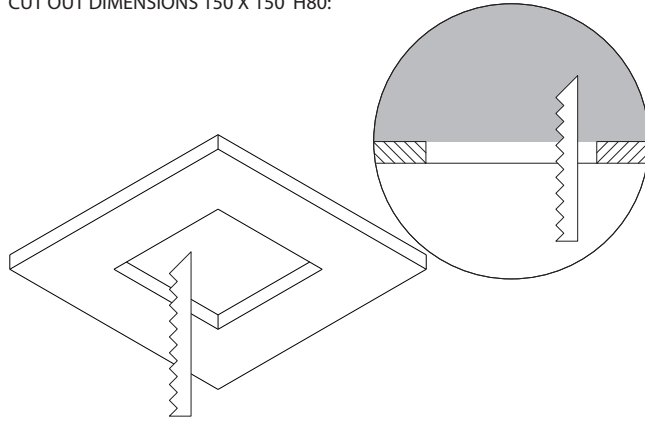

2 SCREW TWO WOODEN BATTENS (NOT INCL.) PARALLEL TO SIDE

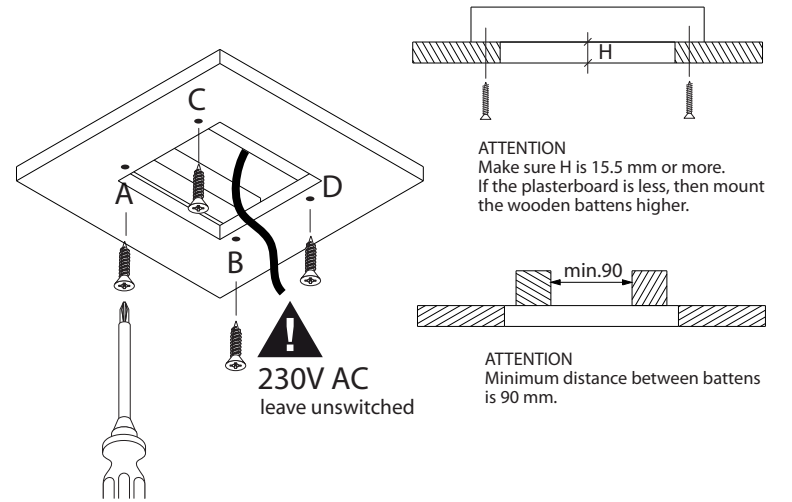

3 FIT THE LAMP INTO THE LAMPHOLDER

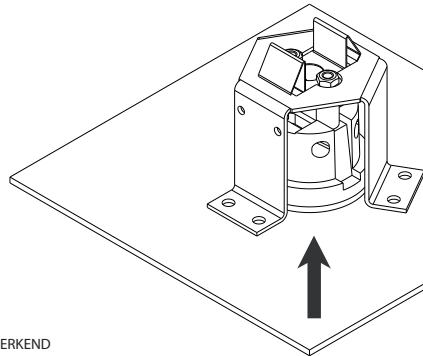

4 PULL OUT LAMPHOLDER + LAMP

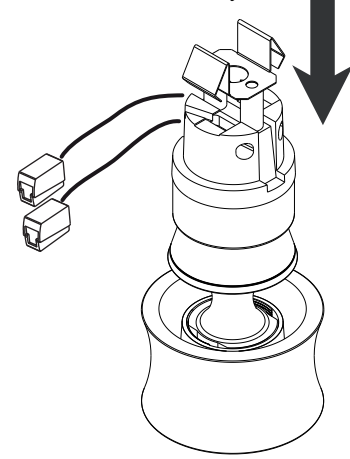
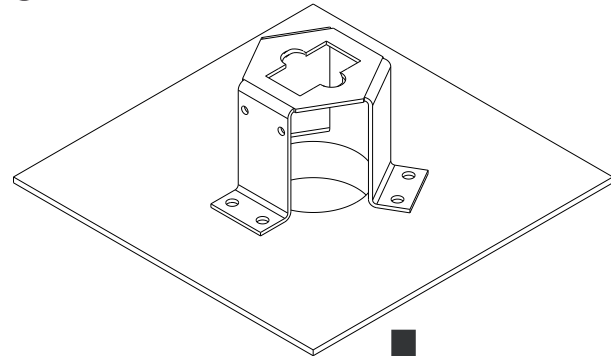

A60 (or CFL or LEDLAMP)
 max.23W (for designer bulb: 7W / 470lm)

INSTALLATIE- EN ONDERHOUDSRICHTLIJNEN m.b.t. FABRIEKSGARANTIE.

1. DE VERBINDINGEN EN HET UITTESTEN VAN DEZE TOESTELLEN DIENEN ALTIJD TE GEBEUREN DOOR EEN ERKEND ELECTRO-INSTALLATEUR.
2. DEZE VERLICHTINGSTOESTELLEN MOETEN GEïNSTALLLEERD, VERBONDEN EN GETEST WORDEN VOLGENS DE NATIONAAL GELDENDE REGLEMENTEN OP DE ELECTRISCHE INSTALLATIES (BELGIË, A.R.E.I., DUITSLAND: DIN VDE 0100 TEIL 559 A2, ...; DEZE OPSOMMING IS LOUWER INFORMATIEF)
3. DE TECHNISCHE BIJSLUITER MOET GEZIEN WORDEN ALS ONDERDEEL VAN DE ALGEMENE VERKOOPVOORWAARDEN VAN TAL N.V.
4. DE ELECTRO-INSTALLATEUR IS VERANTWOORDELIJK VOOR HET GEBRUIKEN VAN VOORSCHAKELAPPARATUUR DIE VOLDOET AAN DE GELDENDE CE EN EMC NORMEN.
5. VERVANG DE LAMP (-EN) ALTIJD MET DE GROOTSTE ZORG, ZE IS (ZIJN) UITERST BREEKBAAR.
6. OPGEPAST: PLAATS NOOIT DE LAMP MET BLOTE HANDEN, GEBRUIK ALTIJD EEN DOEK!

INSTALLATION AND MAINTENANCE INSTRUCTIONS IN VIEW OF THE MANUFACTURER'S GUARANTEE.

1. THE CONNECTION AND TESTING OF THE DEVICES SHOULD ALWAYS BE PERFORMED BY A RECOGNIZED ELECTRICIAN.
2. THESE LIGHTING DEVICES NEED TO BE INSTALLED, CONNECTED AND TESTED FOLLOWING THE OFFICIAL NATIONAL INSTRUCTION GUIDE FOR ELECTRICAL INSTALLATIONS (BELGIUM, A.R.E.I., GERMANY: DIN VDE 0100 TEIL 559 A2, ...; THIS ENUMERATION IS JUST AN INDICATION)
3. THIS TECHNICAL ENCLOSURE NEEDS TO BE ADDED TO THE GENERAL SALES CONDITION OF THE TAL N.V.
4. THE ELECTRO TECHNICIAN IS RESPONSABLE TO USE BALLASTS, TRANSFORMERS,... WHICH MEET THE VALID CE AND EMC RULES.
5. ALWAYS REPLACE THE LAMP (-S) WITH UTMOST CAUTIONSNESS, THE LAMP (-S) IS (ARE) VERY FRAGILE.
6. ATTENTION: NEVER REPLACE THE LAMP WITH BARE HANDS, ALWAYS USE A CLOTH!

5 SCREW THE NUTS TO THE WOODEN BATTENS.

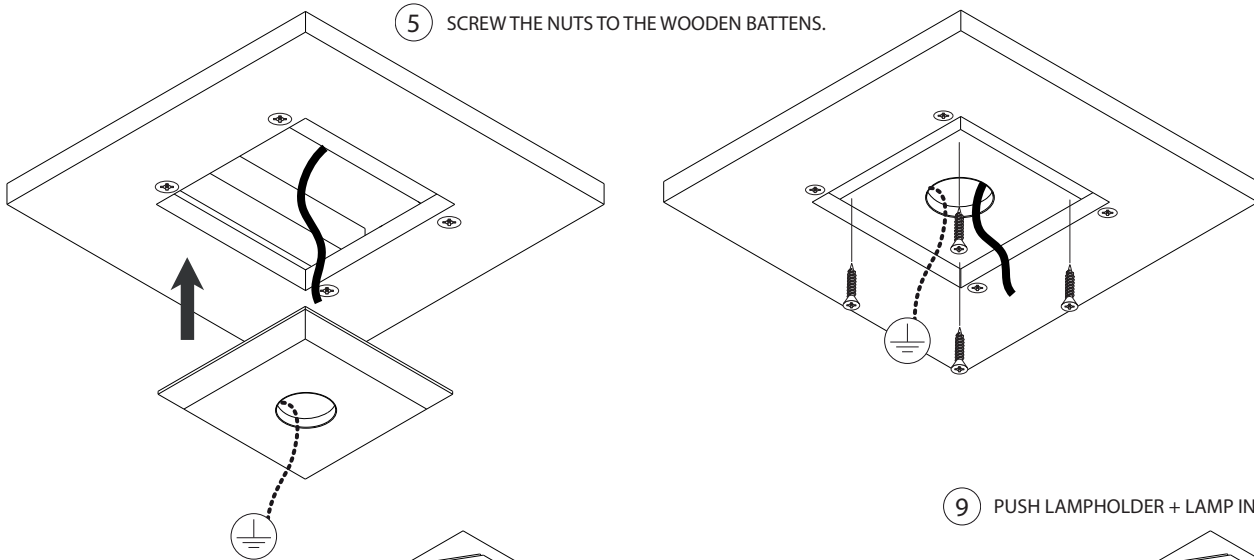

6 FILL THE GAP AND SCREWHOLES AND RUB DOWN WITH SANDPAPER. THE CEILING IS NOW READY TO PAINT.

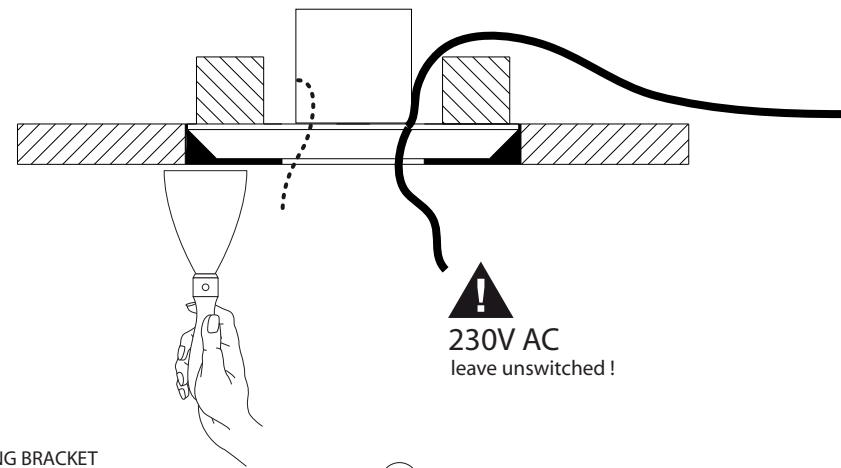

7 MAKE CONNECTION : 230V AC

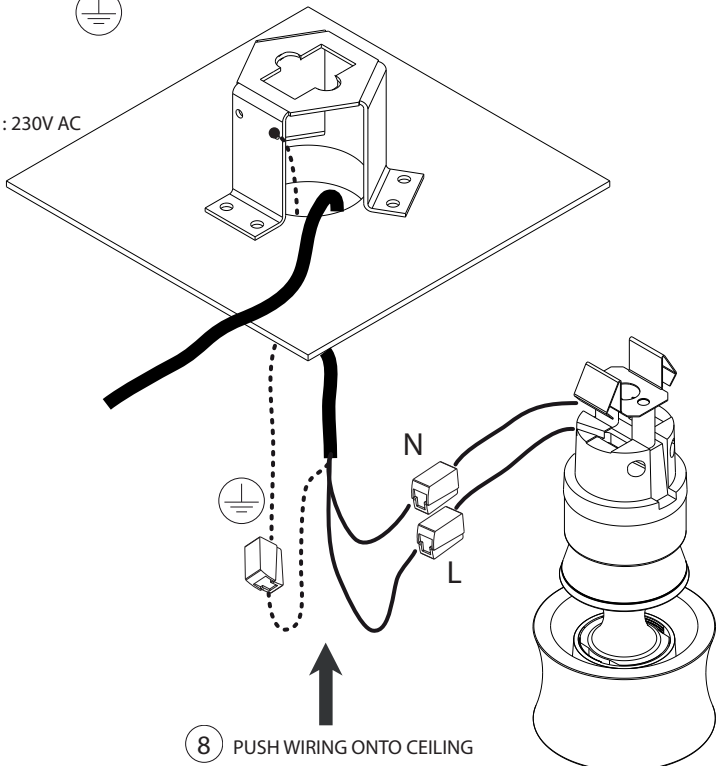

9 PUSH LAMPHOLDER + LAMP INTO CEILING BRACKET

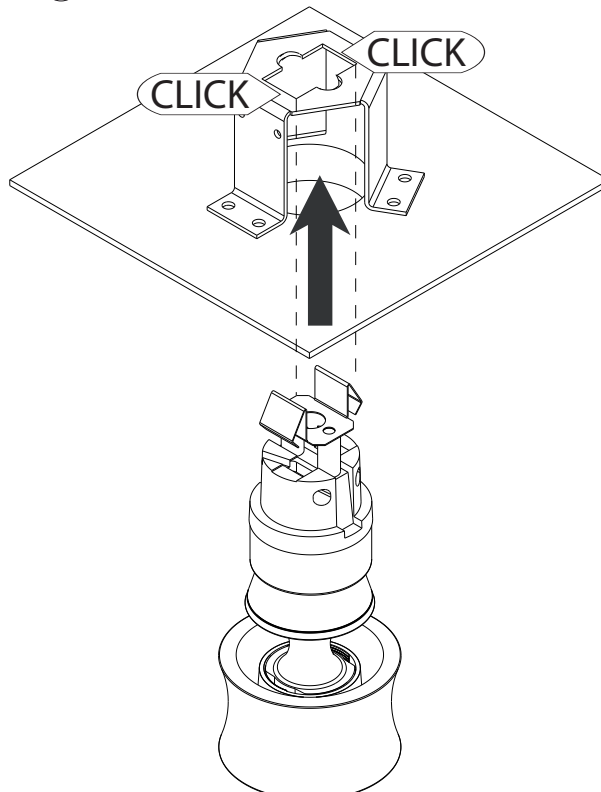

10 SWITCH ON MAINS POWER SUPPLY

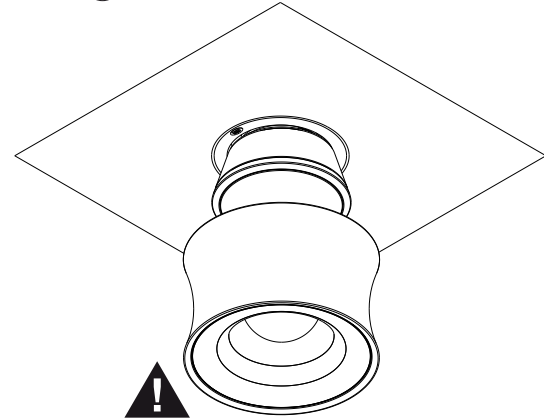

CONCAVE/CONVEX COVER can be easily changed by turning

